



## CPX Container 1700L rectangular

Art.nr: 40815



Requires double  
door



Approximate size

### Specifications

Material	PE
Shape	Rectangular
Design	Open
Color	Natural
Volume (L)	1700
Length (mm)	1150
Width (mm)	1100
Height (mm)	1850
Weight (kg)	60
Tare weight (max kg/l)	1.2
Tollstatistical code	3925100000

Recycling



### Characteristics



Wide  
temperature  
range



Chemical  
resistance



Leak test



Logistics  
solutions



Suitable for  
food contact



Easy to clean

This drawing and design is the property of CIPAX. Copying and distribution of the drawing or any contents is prohibited without written permission from authorised personal at CIPAX

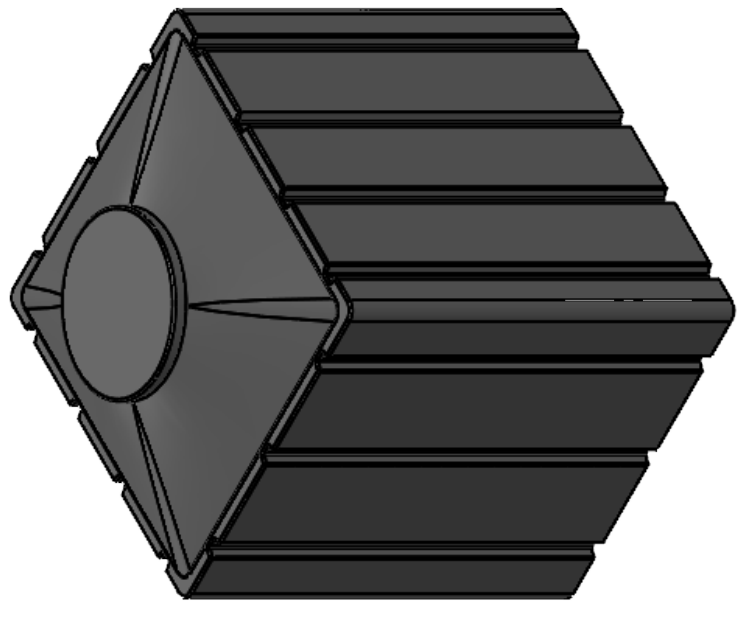
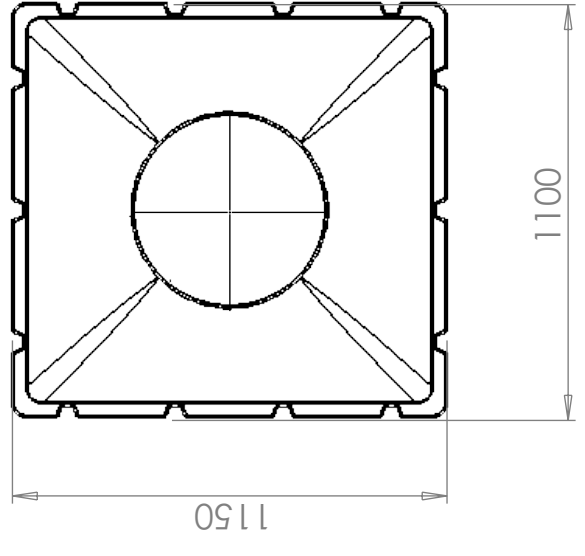
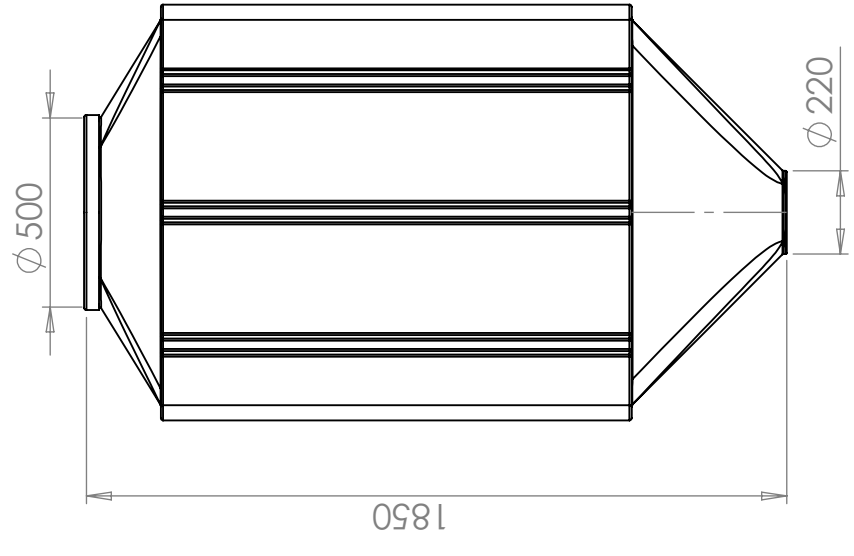
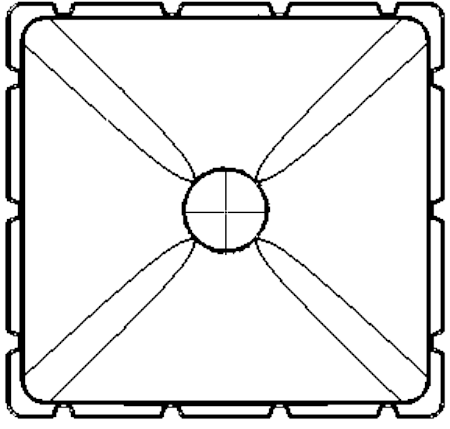

Revision		
REV.	Ändringsmeddelande	Datum
		Godkänd

Konstruerad av	Granskad av	Godkänd av - datum	Generell tolerans SS-ISO 2768-1	Generell Ytjämnhet, Ra	Vyplacering	Skala
		-				1:20
Titel/Benämning						
CPX Behållare 1700L rektangulär						
Ritningsnummer						
40815						
Utgåva						Blad
A						1(1)

