

CPX Storage tank 2200L natural



The tank has a 600 mm O-ring sealed inspection hatch attached to the tank with a painted tubular stand. There are a total of four flat mounting surfaces on the top of the tank and its lower side. The tank is completed as necessary with a safety bund and suitable connections. For tare weight 1.85 kg/dm³.

Art.nr: 12010



Requires double door



Approximate size

Specifications

Material	PE
Shape	Cylindrical
Bottom shape	Straight
Design	Closed
Lid type	
Color	Natural
Volume (L)	2200
Height (mm)	1854
Diameter (mm)	1340
Surface area (m ²)	1.85
Weight (kg)	75
Tare weight (max kg/l)	1.85
Tollstatistical code	3925100000
GTIN	7090046760283

Recycling



Characteristics



Customizable containers



Recyclable



Wide temperature range



Chemical resistance



Leak test



Logistics solutions



Suitable for food contact



Easy to clean

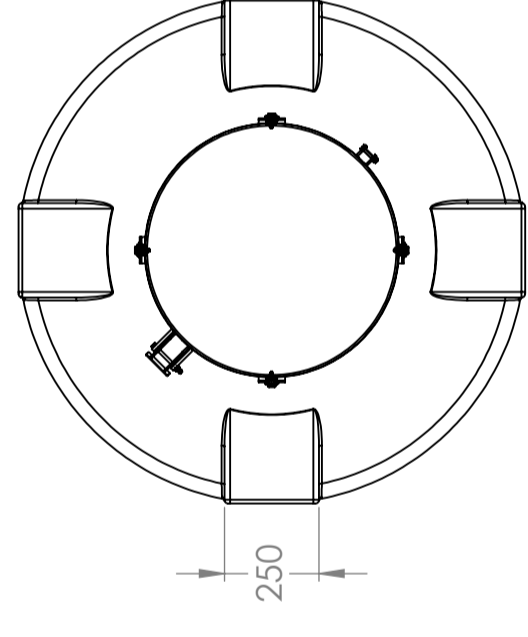
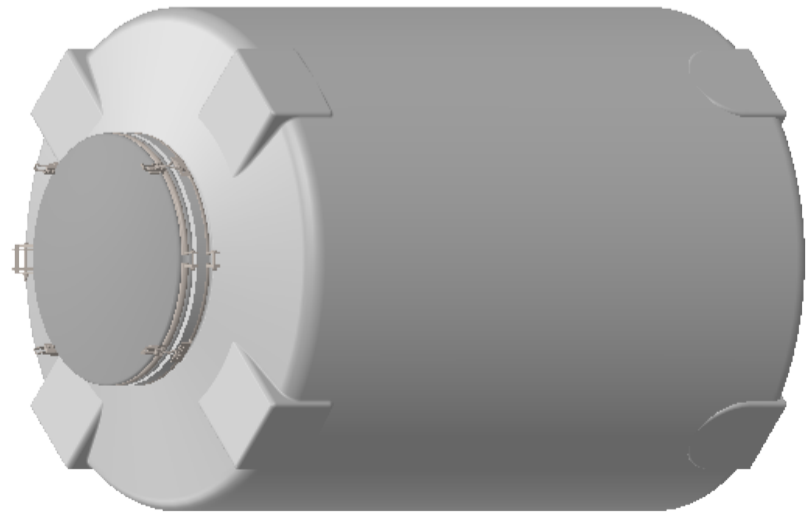
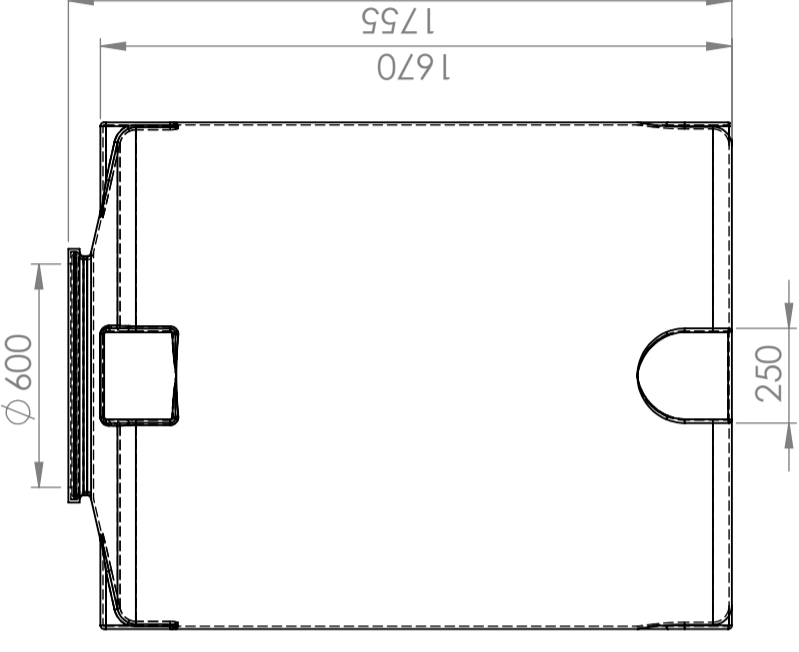
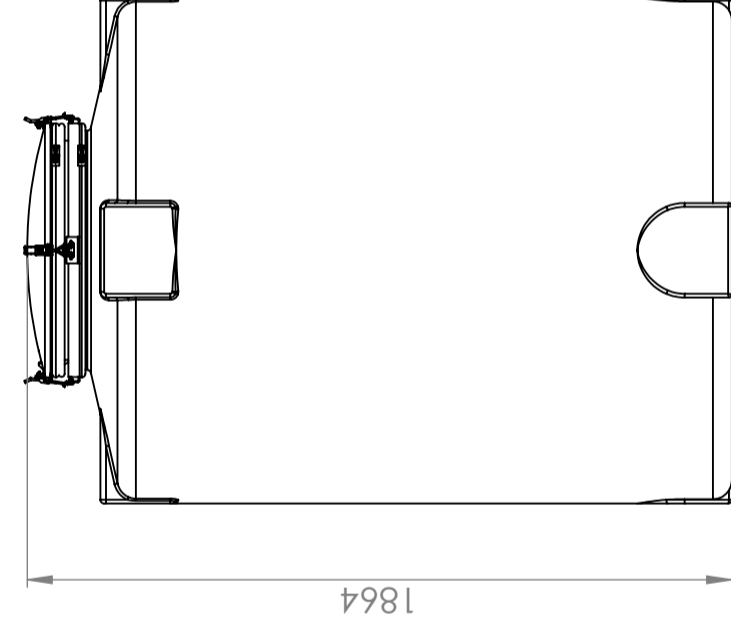
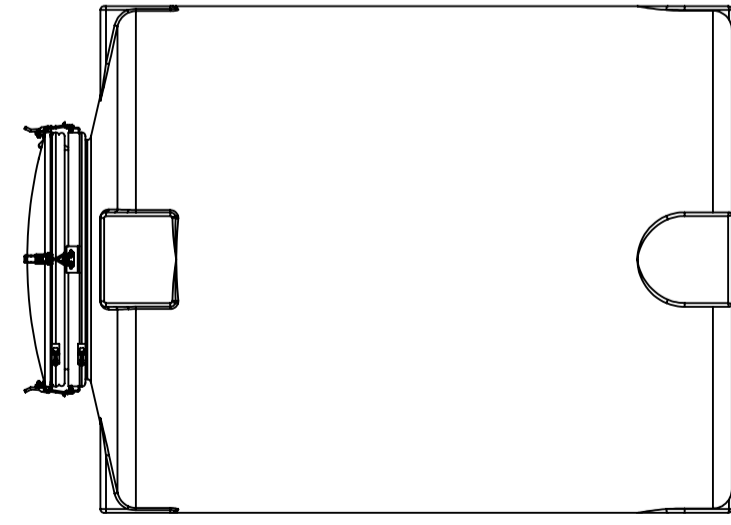

For tare weight 1.85 kg/dm³

* Manhole requires 800mm space to open fully compared to maximum height.

Tilatte avvik for måleområde. Gjelder ved +20° C			
Permissible deviations for basic length size range. Valid +20° C			
0-20	>20-75	>75-150	>150-300
±0.5mm	±1mm	±1.5mm	±1.5%
			±1%

Generelle toleranser om ikke annet er oppgitt på tegning
 General tolerances if not other stated on drawing

Constructed by - date	Evaluated by	Approved by - date	General Tolerances	Finish, Ra	View	Scale
GEP 13.12.2023			NS-ISO 2768-1	PE		1:20
Owner			Title/Description			
CIPAX			12010 CPX Storage tank 2200L Natural			
Drawing number			Revision		Sheet	
1424 - 314					A3 1(2)	

